

Lithium (123)



**Specifications**

**Classification:** "Lithium Photo"  
**Chemical System:** Lithium / Manganese Dioxide (Li/MnO<sub>2</sub>)  
**Designation:** IEC-CR17345  
**Nominal Voltage:** 3.0 Volts  
**Storage Temp:** -40°C to 60°C  
**Operating Temp:** -40°C to 60°C  
**Typical Capacity:** 1500 mAh (to 2.0 volts)  
 (rated at 100 ohms at 21°C)  
**Typical Weight:** 17 grams  
**Typical Volume:** 7.0 cubic centimeters  
**Max Discharge:** 1500 mA continuous (3500 mA pulse)  
**Max Rev Charge:** 2 microampere  
**Typical Li Content:** 0.55 grams  
**Shipping:** For complete details, please reference:  
 Global (except US): Special Provision A45 of the International  
 Air Transport Association Dangerous  
 Goods Regulations  
 United States: 49 CFR 173.185

**Industry Standard Dimensions**

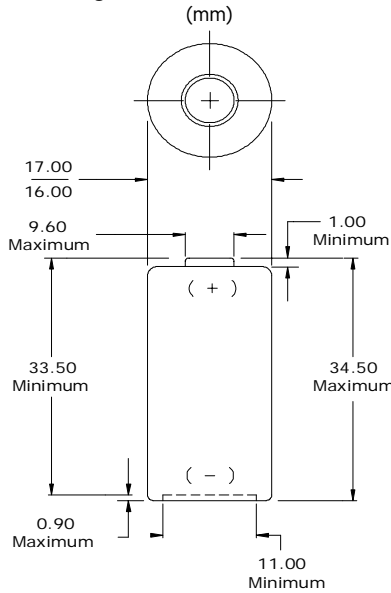

This battery contains a Positive Temperature Coefficient (PTC) safety device to limit current during short circuit conditions.

**Typical Discharge Characteristics**

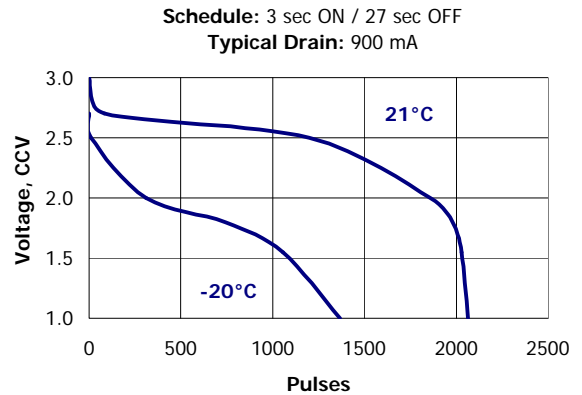

**Simulated Application Tests**

Typical Performance at 21°C

| Schedule (time)        | Drain (mA) | Load (ohms) | Cutoff Voltage |                |               |
|------------------------|------------|-------------|----------------|----------------|---------------|
|                        |            |             | 2.0V (hours)   | 1.55V (pulses) | 1.0V (pulses) |
| Continuous             | ---        | 100         | 60             | ---            | ---           |
| Continuous             | 1000       | ---         | 1.2            | ---            | ---           |
| 3 sec ON<br>7 sec OFF  | 1200       | ---         | ---            | ---            | 1500          |
| 3 sec ON<br>27 sec OFF | 900        | ---         | ---            | 2000           | ---           |

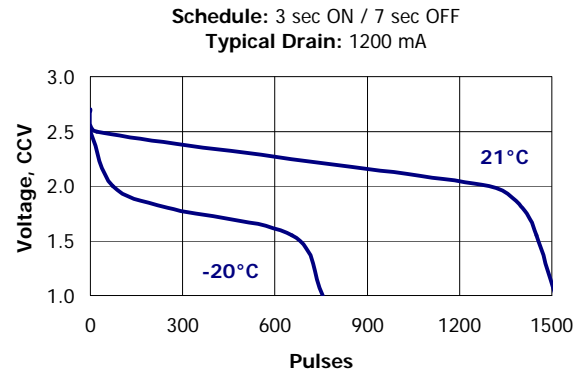

**Important Notice**

This data sheet contains typical information specific to products manufactured at the time of its publication.  
 ©Energizer Holdings, Inc. - Contents herein do not constitute a warranty.